

exway

Swappable Power System User Manual



WARNING

- Do not touch while in operation to avoid injury!
- For use with exway components only! Please use the supplied hardware.
- After installation, please ensure that the screws are tightened to avoid noise caused by vibration!
- The rear truck won't work properly when "power System" at the App is not set correctly, this may also damage the device!
- Exway products and apps will be updated constantly. Please refer to the App or official website for the latest details.

www.exwayboard.com

Follow YouTube @exwayboard6 for corresponding video tutorials

Riot

Disassembling →
Installing ←

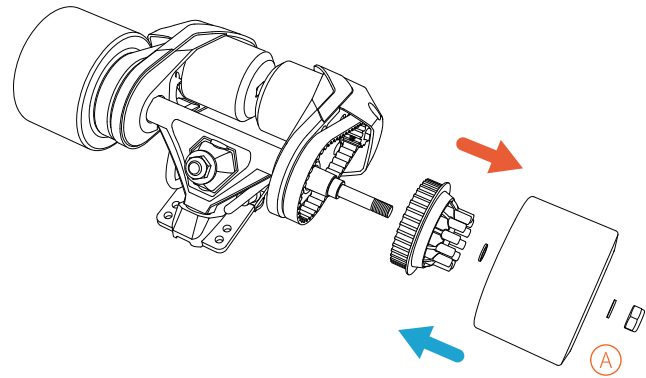

Step 1: How to replace the wheel?

1. Follow figure (A) to remove the nut and gasket and then remove the wheel.
2. Align the new wheel holes with the drive gear.
3. Tighten nuts after mounting the gasket back.

Step 2: How to replace the driven gear?

Rotate the driven gear and wheel and then press into the belt.

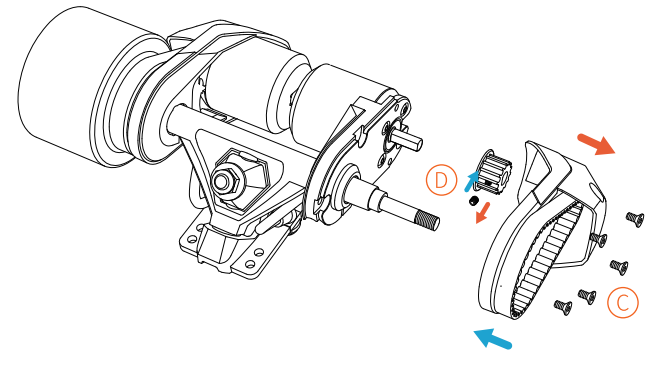

Step 3: How to replace the protective motor cover?

1. Use an Allen wrench to remove the screws and then the protective motor cover. See figure (D).
2. Replace the motor protective cover and install the screws.

Step 4: How to replace the belt?

After putting the belt on the drive gear, install the protective motor cover and tighten the screws.

Step 5: How to replace the alloy drive gear?

After installing the new drive gear, screw in the set screws with threadlock and tighten them.

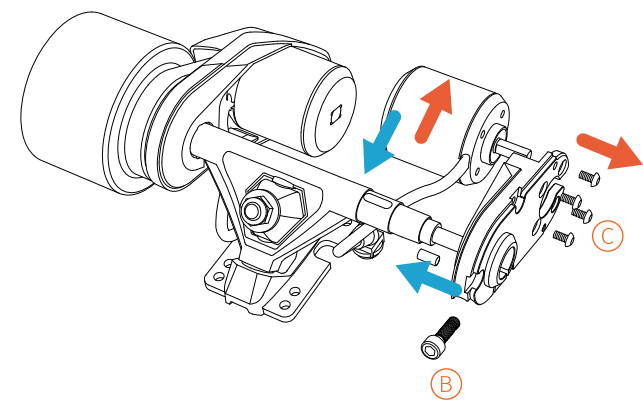

Step 6: How to replace the motor?

1. As in figure (C), unscrew the 4 screws with an Allen wrench and then remove the motor.
2. Load the new motor into the motor bracket and make sure its outlet position is aligned with the truck. Install the bolts, but do not tighten them.
3. After installing the new drive gear, screw in the set screws with threadlock and tighten them.
4. Install the belt and driven gear, adjust the belt tension and tighten the motor screws.

Step 7: How to replace the motor bracket?

1. As in figure (B), use the Allen wrench to remove the bolts on the motor bracket.
2. Put the dowel pin back, install the new motor bracket onto the truck hanger and tighten the bolts.

(A)

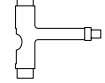

T-tool



10#-32 Bolt



10# Nut

(B)



5mm Allen Wrench



M6*20 Bracket Bolt

(C)



2.5mm Allen Wrench



M3*53 Sleeve Bolt



M4*10 Motor Cover Bolt



M4*8 Motor Cover Bolt



M4*6 Motor Bolt

(D)



2mm Allen Wrench



M4*5 Set Bolt



8.1*11 Bearing Ring



Bearing



Speedring



Dowel Pin

Riot & Pro

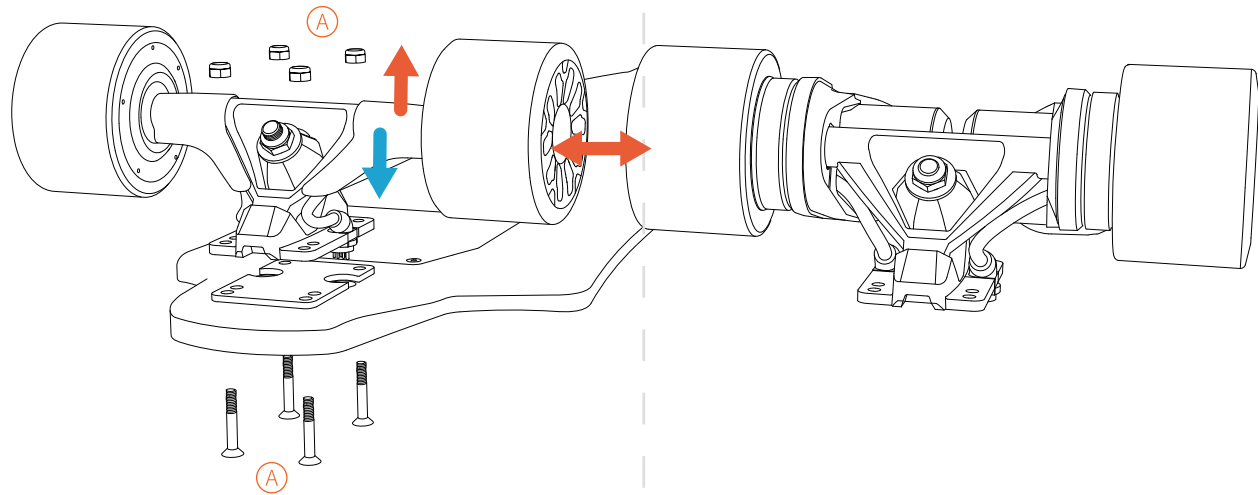

How to replace the power system?

1. Remove part of the grip tape from the tail side. Unscrew the bolts.
2. Mount the new power system and tighten the bolts.
3. Select the correct "Power System" mode from the Exway App.
4. Save the setting and exit the App.
5. Reboot the skateboard board and remote control.



WARNING

- The rear truck won't work properly when "power System" at the App is not set correctly, and this may also damage the device!
- After changing the power system, both the skateboard and remote control have to be re-booted.
- After installing the new drive gear, the set screws have to be fixed with threadlock.

Riot & Pro

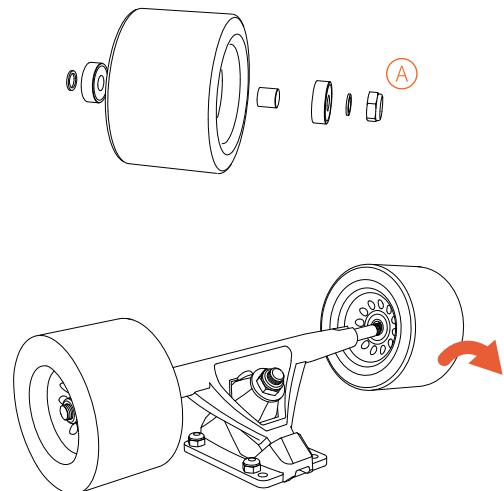

How to change the front wheel bearing?

1. Follow (A) to remove the nut and gasket and then remove the wheel.
2. As shown in the picture, rest the single bearing of the wheel on the axle of the truck and pry it out one by one.
3. Put the new bearing and then the wheel on the axle of the truck, press hard to mount them back.

Pro

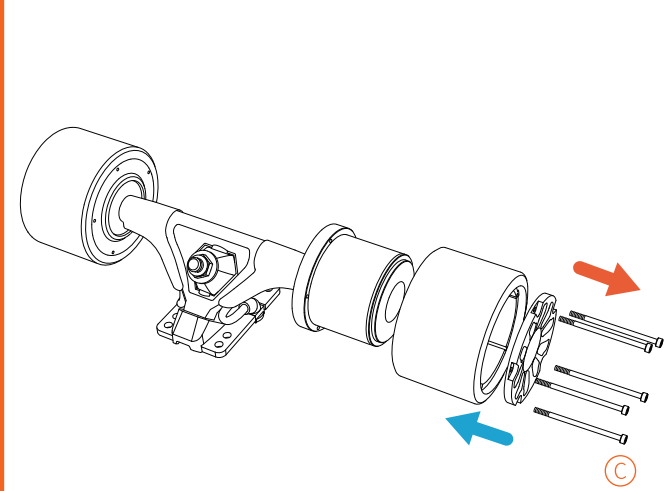

How to replace the motor cover?

1. Unscrew the bolts with an Allen wrench and change the motor cover.
2. Put threadlock at screw holes and tighten the bolts.

How to replace rear wheel sleeve?

1. As in figure (C), insert the Allen wrench through one of the bolt holes on the sleeve to assist positioning.
2. Insert and tighten the rest bolts after installing the motor cover.

⚠ SPECIAL NOTES

- Put appropriate amount of threadlock to the screw holes before changing.
- Do not tighten the first bolt during installation.
- Check to ensure each bolt is tightened after installation.

Exway Wheel

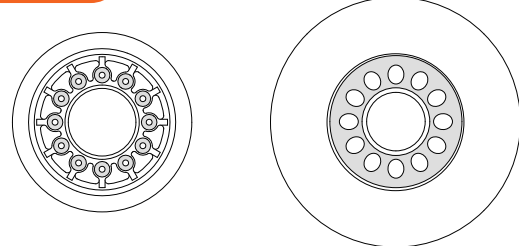

Elliptical Hole

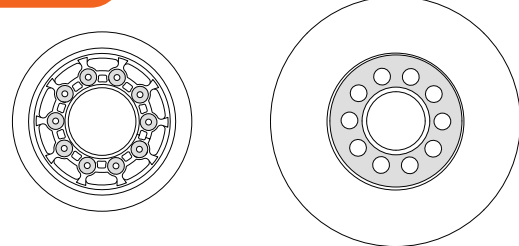

Star-Hole

